

Nailbase

The following instructions are provided for the installation of ThermaFoam R-Control Nailbase insulation. The instructions herein provide general guidance only and do not cover all aspects related to the installation or use of insulation in a building.

Before starting, ensure that the installation complies with the applicable building code requirements. The building code may have requirements for thickness and R-value of the insulation, vapor retarders, interior thermal barriers and finish materials, exterior weather resistive barriers and claddings, ventilation, insulation in adjacent areas, caulking and sealing, and other items.

As the installer, you are solely responsible for the proper installation of all materials, following product label instructions and for using proper safety precautions during installation to avoid injury. ThermaFoam is not responsible for building design and accepts no responsibility for the performance of its products resulting from improper building design, construction faults, or defective installation workmanship.

Tools Needed

- Tape Measure
- Utility Knife
- Straightedge
- Cordless Drill
- Saw
- Hammer
- Nail Gun
- Caulk Gun

Protective Gear

- Work Gloves
- Loose-fitting, long-sleeved shirt
- OSHA-approved safety glasses
- Disposable dust respirator (NIOSH or MSHA approved)
- No requirement for re-entry or re-occupancy times.

APPLICATION OF THERMAFOAM R-CONTROL NAILBASE TO A CONCRETE WALL:

1. Remove any obstacles or debris from the wall and area of work that may interfere with the attachment of the Nailbase.
2. Cut the Nailbase to match the wall height.
Note: Cut the Nailbase as needed to fit tightly around pipes, ducts, vents, openings or similar objects.
3. Install lumber blocking as required.
4. Using foamboard compatible adhesive, apply the adhesive to the wall, or directly to the Nailbase, in vertical beads approximately 12" apart.
5. Press/hold the Nailbase firmly to the wall.
6. Attach using concrete fasteners through the Nailbase into the concrete wall. Fastener spacing must be no greater than 24" along the length of the Nailbase.
Note: ThermaFoam R-Control Concrete Fasteners for concrete masonry units or solid concrete walls are available from ThermaFoam.
Note: OSB Facing must not be in contact with concrete.
7. **Interior Application:**
 - a. Install vapor retarder, as required, in compliance with the applicable building code.
 - b. Install a code compliant thermal barrier, such as 1/2" gypsum board, to the Nailbase per the requirements of the applicable building code.**Exterior Application (above grade):**
 - a. Install a code compliant weather resistive barrier.
 - b. Install a weather resistive exterior cladding in compliance with the applicable building code.

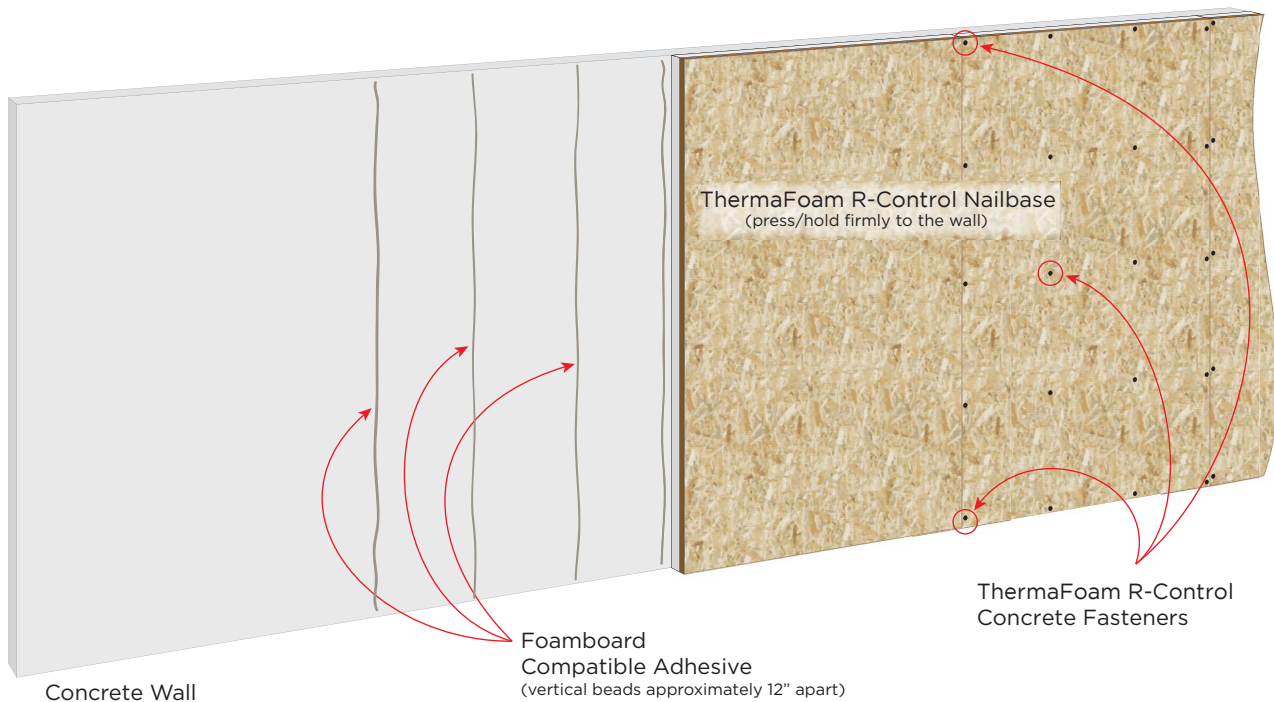

APPLICATION OF THERMAFOAM R-CONTROL NAILBASE TO A WOOD FRAMED WALL:

1. Remove any obstacles or debris from the wall and area of work that may interfere with the attachment of the Nailbase.
Note: The wall to receive the Nailbase must be braced or sheathed in compliance with the applicable building code.
2. Cut the Nailbase to match the wall height.
Note: Cut the Nailbase as needed to fit tightly around pipes, ducts, vents, openings or similar objects.
3. Install lumber blocking as required.
4. Using foamboard compatible adhesive, apply adhesive to the wood studs.
5. Press/hold the Nailbase firmly to the wall.
Note: All vertical edges of the Nailbase must be supported by the wood studs.
6. Attach using wood fasteners through the Nailbase into the wood studs. Fastener spacing must be no greater than 24" along the length of the Nailbase.
Note: ThermaFoam R-Control Wood Fasteners for wood framed walls are available from ThermaFoam.
7. **Interior Application:**
 - a. Install vapor retarder, as required, in compliance with the applicable building code.
 - b. Install a code compliant thermal barrier, such as 1/2" gypsum board, to the Nailbase per the requirements of the applicable building code.**Exterior Application (above grade):**
 - a. Install a code compliant weather resistive barrier.
 - b. Install a weather resistive exterior cladding in compliance with the applicable building code.

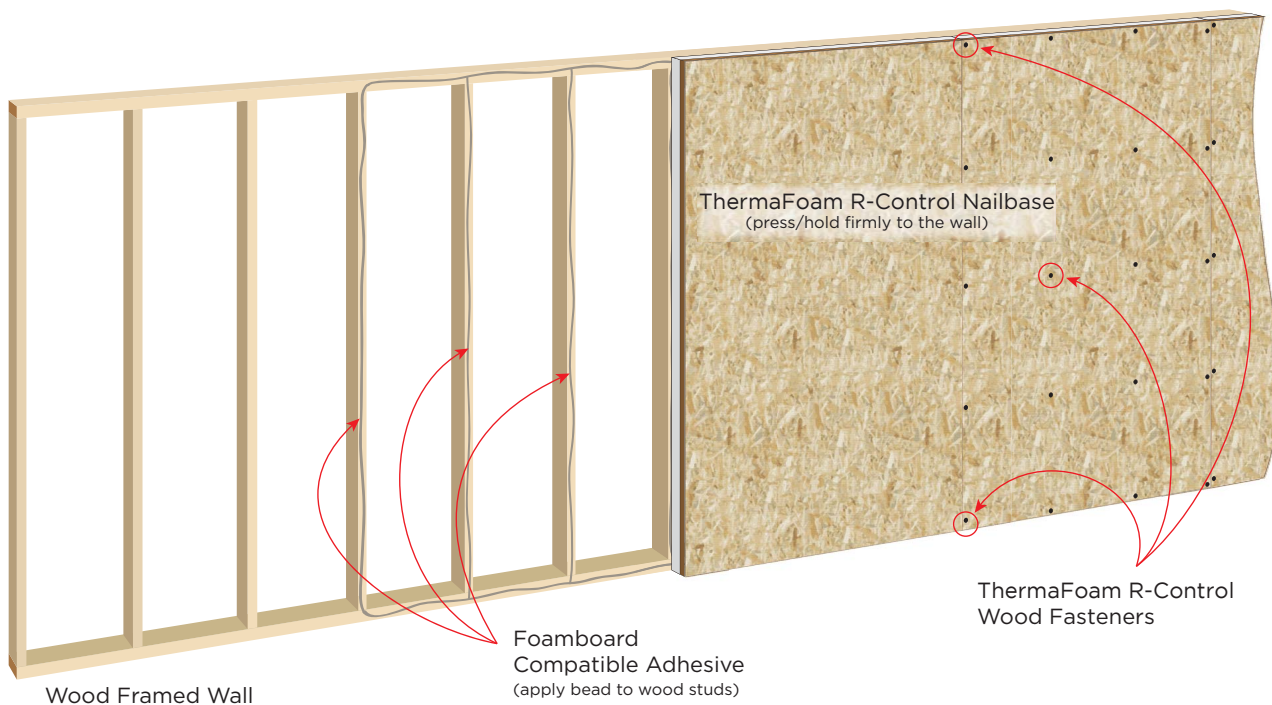

Notice: ThermaFoam R-Control insulation contains a flame retardant; however, it should be considered combustible and should not be exposed to sources of ignition. The product will ignite when exposed to open flame or welding torches.